

GLOBAL SENSORS NEW ITEM

Ideal Solution to Dry Ice Storage and Shipping Checks

Now the reliable and accurate LogTag formula works at Dry Ice temperatures. Many applications for the storage and shipment of products require extreme low temperature. Maintaining these critical temperatures is always a challenge, and one wants to know if proper temperatures were held.

Like other LogTag models, the Dry Ice models excel at performance. Temperature accuracy is unmatched, providing a "true" $\pm 1.0^{\circ}\text{C}$ accuracy in the critical recording range. Most recorders claim this level of performance, but do not hold 100% of their product within those stated limits. The LogTag Dry Ice logger does. It is a recording device that with valid performance statistics delivers known accuracy as a standard feature.

Choose the external probe model for applications that require separation or the integral sensor model for better economy.

Global Sensors LogTag Dry Ice Model

Call for pricing and options.

© 2011 Global Sensors, LLC
All rights reserved.

Global Sensors LogTag Dry Ice Temp Loggers

Please call us for guidance in selecting your Dry Ice model type.

We do not publish our price since our online deals are the best. We will match or better any Internet pricing.

External probe option (TREL-8) is our most popular dry ice model:

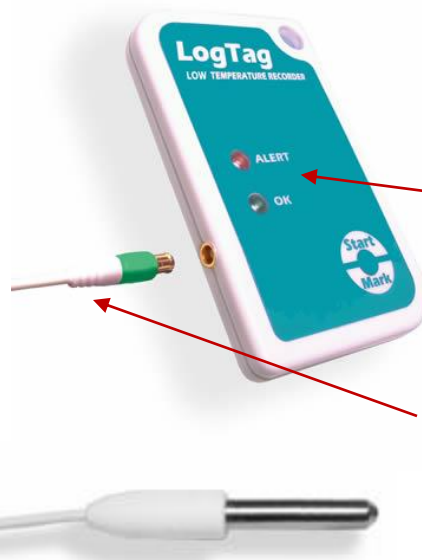

Probe plug in is a high quality corrosion resistance material with a solid "snap" fit.

External probe cable with special dry ice tip. Cable length options are 0.5 meters (19") or 3.0 meters (9'10") in length.

All functions are the same as a standard LogTag unit. Start and Mark function is the same and unit size is the same.

LED lights respond to alerts: preset absolute max and min, time over and under low and high presets

The other option is an integral sensor dry ice model available as:



Single Use model: SRIL-8

OR

Multi Use model: TRIL-8

PRODUCT SPECIFICATIONS

PS#60

Temperature Range	-80°C to +40°C (-112°F to +104°F)
Temperature Resolution	< 0.1°C for -80°C to 0.0°C, < 0.2°C for 0.0°C to +20°C, < 0.5°C for +20°C to +40°C
Temperature Accuracy	better than ±1°C for -30°C~ +20°C better than ±1.2°C for -45°C~ -30°C & +20°C~+40°C better than ±1.7°C for -80°C~-45°C
Sensor Response	T ₉₀ of less than 5 minutes in moving air
Stored Time-Temperature Readings	8032 readings (16K bytes memory)
Time Accuracy	Average 20 Seconds per Month
Logging Interval	Adjustable, 30 sec to several hours
Battery Type and Life	3V Lithium battery - Three years of use
Size and Weight	Dimensions 8.6cm x 5.5cm x 0.86cm (L x W x H) 3 ³ / ₈ " x 2 ¹ / ₈ " x 5 ¹ / ₁₆ " Unit Weight 35 g (0.08 lb. or 1.23 oz.)
Indicator Lights	Flashing 'OK' indicator Flashing 'Alert' indicator
Case	Polycarbonate (Case and face label are G.R.A.S. materials per USDA)
Basic Features	Logging start by push button or specific date/time start Optional clearing of alert indication by push button (places inspection make at same time).
Mark	Download inspection mark recorded in LogTag memory every time LogTag is downloaded.
Failsafe feature	'Prestart' fail-safe logging (records temperature data even if not started)
Compliance	EMC Compliance Tested and complies with EC EMC directives (EN 50081-1:1992 & EN 61000-6-1:2001) EN12830 Compliance Tested and complies to EN12830:1999 for transport, storage and distribution of chilled, frozen, deep frozen, quick-frozen food and others. WHO Compliance Approved by the World Health Organization authorities.

